

Bylaw 4/2018

Sturgeon County
City of St. Albert

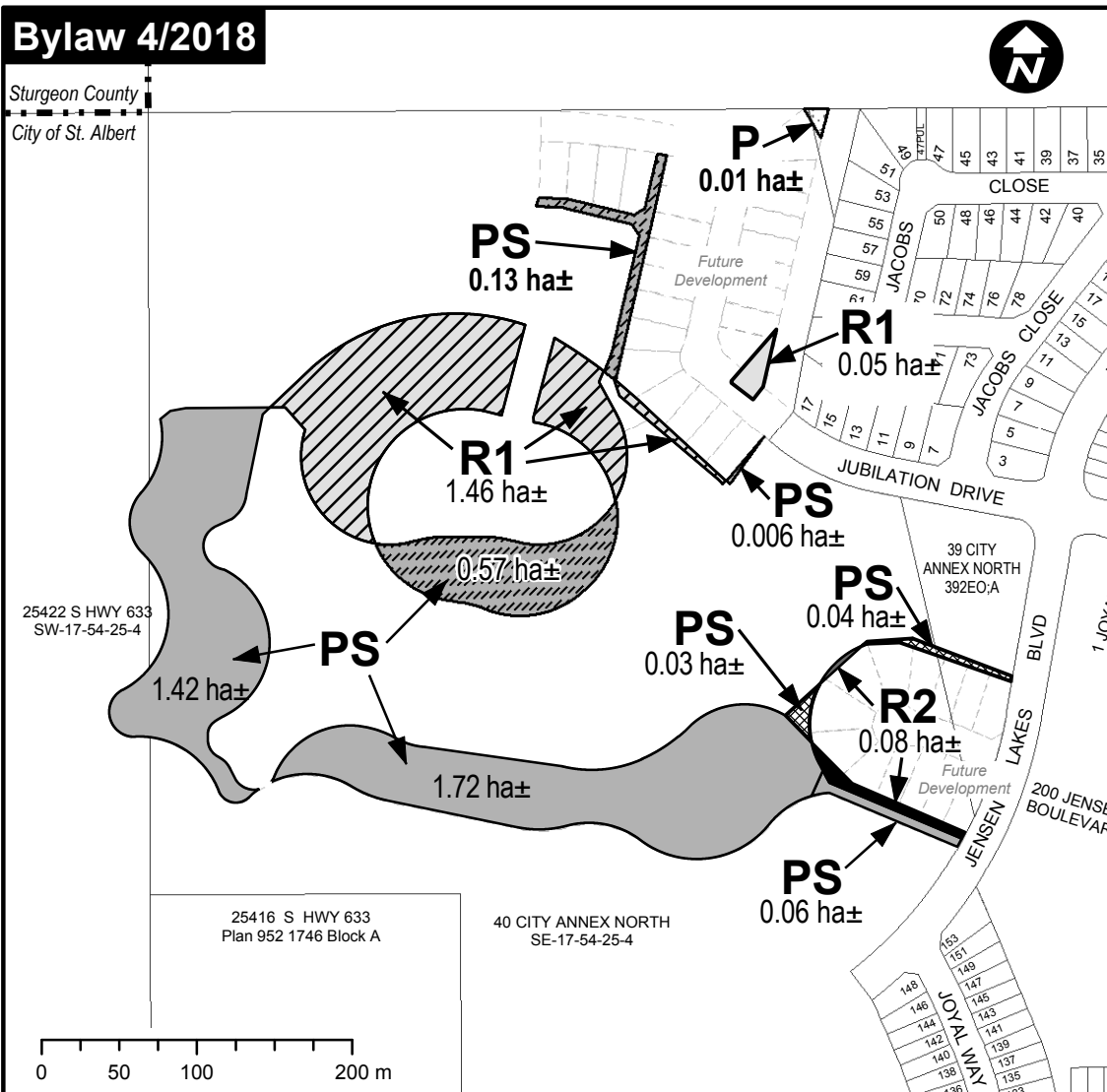

LAND USE BYLAW AMENDMENT Jensen Lakes 7th Redistricting

From: R1 (Low Density Residential)

To: P (Public Park)

PS (Public and Private Service)

From: R2 (Low Density Residential)

To: PS (Public and Private Service)

From: P (Public Park)

To: R1 (Low Density Residential)

From: PS (Public and Private Service)

To: R1 (Low Density Residential)

R2 (Low Density Residential)

From: UR (Urban Reserve)

To: R2 (Low Density Residential)

PS (Public and Private Service)

Jensen Lakes 7th Redistricting

G:\MAPS-City\Jensen Lakes\JL 07 Subdiv and Redistricting\Redistricting\Fig2_RedistrictingVersion3_March7_2018.mxd

Figure 2