

CITY OF ST. ALBERT

BYLAW 13/2017

Being Amendment 143 to Land Use Bylaw 9/2005
(Riverside Stage 17)

NOW THEREFORE the Council of the City of St. Albert, duly assembled, hereby ENACTS AS FOLLOWS:

1. Schedule "A", being the Land Use District Map to Land Use Bylaw 9/2005, is amended by this Bylaw.
2. The lands described and shown on the map below shall be redistricted from Urban Reserve (UR) to Public Park (P), Public and Private Service (PS), Medium/High Density Residential (R4), and Low Density Residential (R2)

Municipal Address
500 Meadowview Drive
8 Genstar Annex

Legal Address
Plan 932 1088, Area A
Plan 152 4950, Block 1, Lot 8

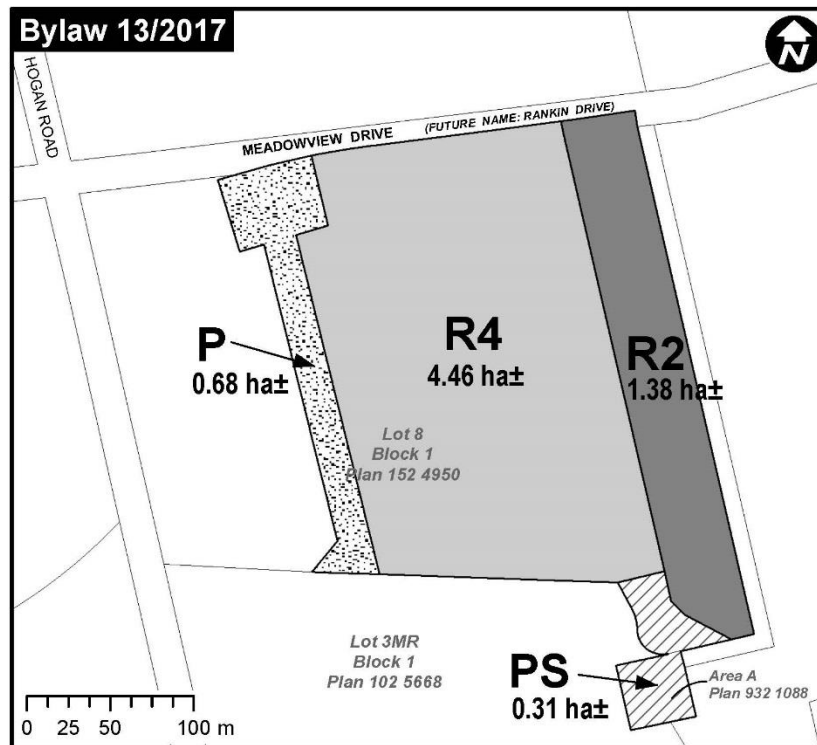

3. The Chief Administrative Officer is authorized to consolidate Bylaw 9/2005.

READ a first time this day of , 2017.

READ a second time this this day of , 2017.

READ a third time this day of , 2017.

SIGNED AND PASSED this _____ day of _____, 2017.

MAYOR

CHIEF LEGISLATIVE OFFICER