

# Proposed Boundary Adjustment

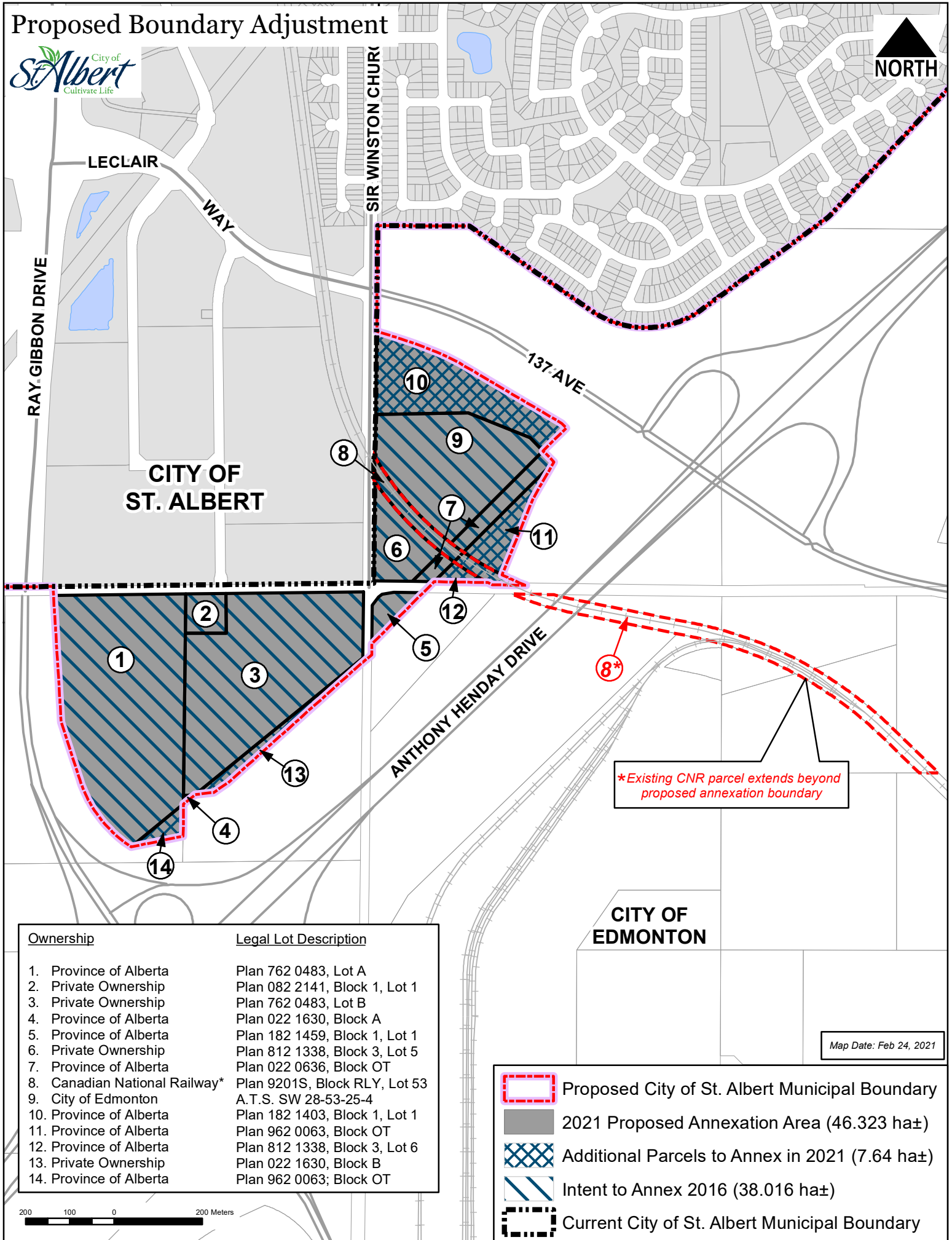

Ownership	Legal Lot Description
1. Province of Alberta	Plan 762 0483, Lot A
2. Private Ownership	Plan 082 2141, Block 1, Lot 1
3. Private Ownership	Plan 762 0483, Lot B
4. Province of Alberta	Plan 022 1630, Block A
5. Province of Alberta	Plan 182 1459, Block 1, Lot 1
6. Private Ownership	Plan 812 1338, Block 3, Lot 5
7. Province of Alberta	Plan 022 0636, Block OT
8. Canadian National Railway*	Plan 9201S, Block RLY, Lot 53
9. City of Edmonton	A.T.S. SW 28-53-25-4
10. Province of Alberta	Plan 182 1403, Block 1, Lot 1
11. Province of Alberta	Plan 962 0063, Block OT
12. Province of Alberta	Plan 812 1338, Block 3, Lot 6
13. Private Ownership	Plan 022 1630, Block B
14. Province of Alberta	Plan 962 0063; Block OT

\*Existing CNR parcel extends beyond proposed annexation boundary

Map Date: Feb 24, 2021

- Proposed City of St. Albert Municipal Boundary
- 2021 Proposed Annexation Area (46.323 ha±)
- Additional Parcels to Annex in 2021 (7.64 ha±)
- Intent to Annex 2016 (38.016 ha±)
- Current City of St. Albert Municipal Boundary

